

RUBINETTO A SFERA FILETTATO

Passaggio ridotto 3 vie in ottone PN 16/40

Art. 039.3300 Passaggio "T"

Art. 039.3400 Passaggio "L"

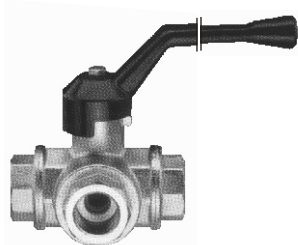

Art. 039.3300
Art. 039.3400

Esecuzione: corpo, manicotto e sfera in ottone CW617N - asta, bussola premiguarnizione e ghiera in ottone CW614N - leva in alluminio EN-AC 46100 in 1706 - guarnizioni in NBR - o-ring in NBR - vite in acciaio CL 04 - passaggio ridotto con manovra a "T" o a "L" - attacchi a manicotto filettati gas F/F/F UNI ISO 228/1-G.

Diametri: 1/4" ÷ 2"

Pressione d'esercizio 16 bar ÷ 40 bar
Temperatura d'esercizio -20°C +160°C

Impieghi: impianti idrotermici e industriali.

Manovra passaggio a "T" Art. 039.3300

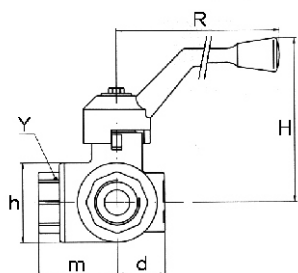

Art. 039.3300
Art. 039.3400

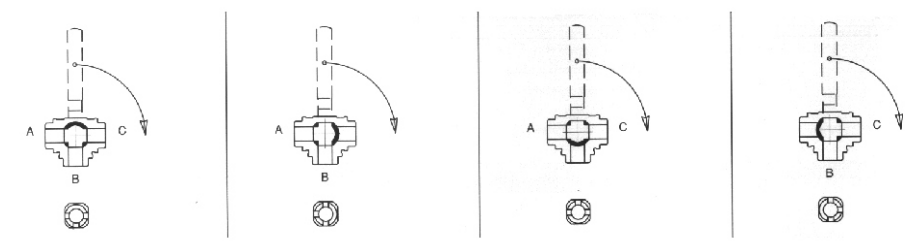

Manovra passaggio a "L" Art. 039.3400

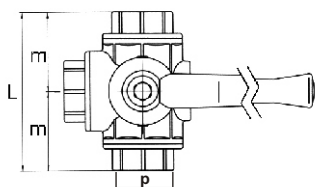
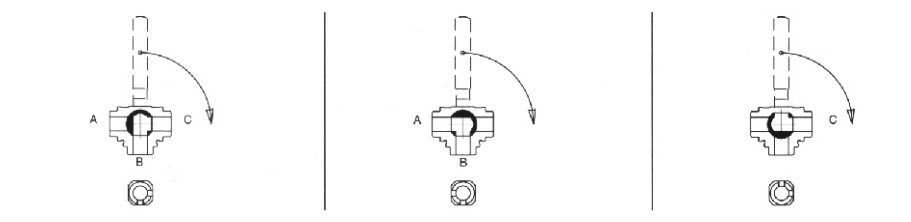

Art. 039.3300
Art. 039.3400

Dimensioni

Ø	øP	øH	I	L	m	Y	R	H	d	PN	Peso "T" Kg	Peso "L" Kg
1/4"	11	39	12.5	80.5	40.2	22	134	77.5	23	40	0.77	0.77
3/8"	11	39	12.5	80.5	40.2	22	134	77.5	23	40	0.73	0.74
1/2"	11	39	14	80.5	40.2	31	134	77.5	23	40	0.76	0.76
3/4"	15	47	14	93.4	46.7	34	170	94	28	40	1.25	1.25
1"	20	54	17	107.3	53.6	41	205	107	31.5	25	1.91	1.92
1 1/4"	25	66	19	118	59	50	205	111	35.5	16	2.61	2.65
1 1/2"	32	80	23	141	70.5	57	205	117.5	43.5	16	4.05	4.25
2"	40	95	27	164	82	70	260	132	48.3	16	6.60	6.70